



Fabric SEG (Silicone Edge Graphic)

INSTALLATION & CARE GUIDE

ver. 070623

For Support Call: 603.436.8210

SEG Installation



① Starting with the top right hand corner of the frame, insert about an inch of the silicone gasket into the metal track. Repeat this process on the top left and bottom corners.

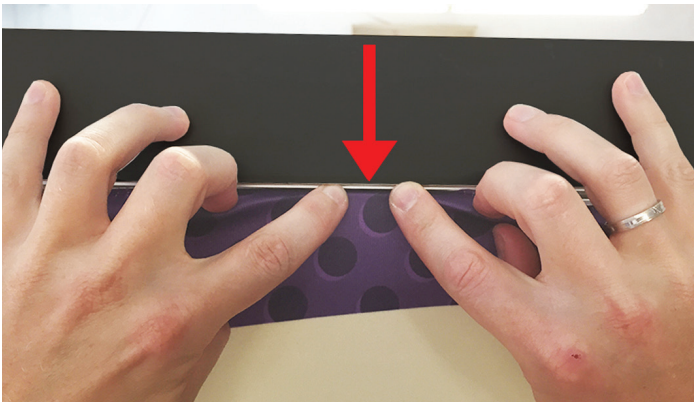

② From the top center of the frame, insert the silicone gasket into the metal track.



③ Using your index fingers, smooth outward towards the corners, guiding the silicone gasket into the metal track. Repeat this process for the bottom and both sides. Do not stretch the silicone gasket into place, it will not return to the original size.

Fabric Care

Handling Tips

- ① Wrinkles can be removed from the fabric with a cool iron or fabric steamer.
- ② Fabric should not be stored when damp.
- ③ Never spot-clean the backlit fabric. It needs to be fully submerged for any cleaning.

Washing or Dry Cleaning

- ① Your fabric graphics can be washed or dry cleaned. Remove any hardware attached to the fabric prior to cleaning. Be sure to use mild soap, cool water and cool heat to prevent the fabric from shrinking.
- ② Fabric must be completely dry before storing or reinstalling.