



Stud Mounted ACM Sign

INSTALLATION GUIDE

SKU# N/A | ver. 062323

For Support Call: 603.436.8210

Sign Installation

1 Insert Studs

Start by hand threading the studs into the perforated pads on the back side of the sign. Hand tighten (do not use pliers or other tools).

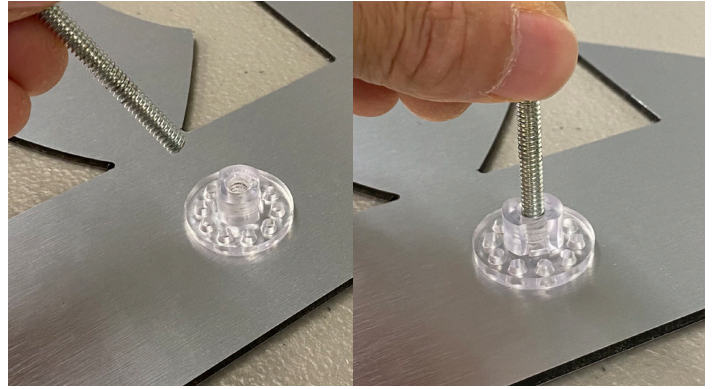

2 Check Template

Lay the paper template on a flat surface. Carefully place the sign (stud side down) on the paper template, aligning the outer edge of the sign with the outline of the pattern. The studs should align with the drill holes markings on the pattern. If any of the studs are misaligned with the markings shown on the pattern- use a pencil/pen to trace the correct position of stud on the paper template.

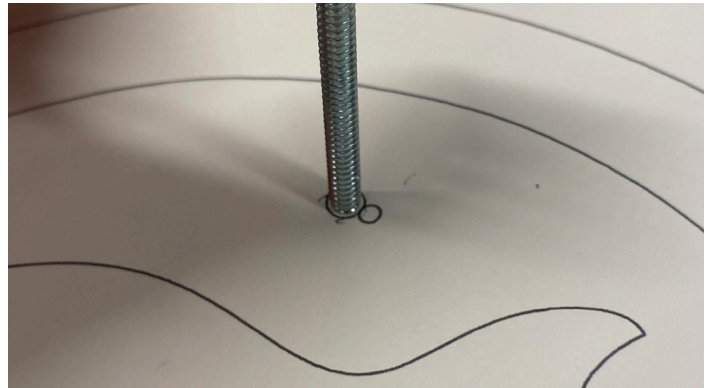

3 Hang Template

Center & level the paper template on the desired mounting location and secure with masking tape.

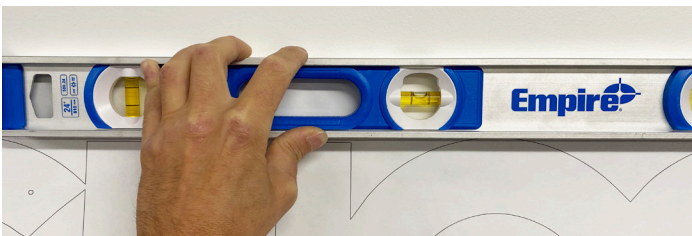

4 Mark Stud Locations

Using a screw, nail, or other sharp object, push the sharp end through the paper template, marking the mounting surface.

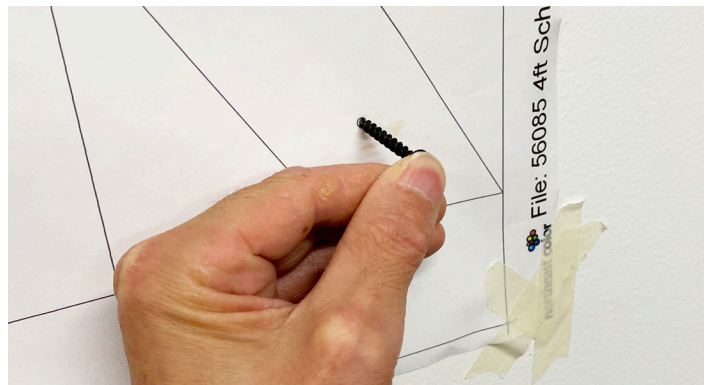

Sign Installation

5 Pre-Drill Holes

Remove the paper template and hold the sign up to the markings, double checking the stud alignment. Drill through the mounting surface.



6 Prep Drill Holes

Inject clear silicone into the pre-drilled holes making sure to keep the areas around the holes clean.



7 Mount Sign

Insert the aluminum tubes over the studs and carefully mount the sign onto the surface by aligning the studs with the holes. Push the sign in until the aluminum tubes meet the mounting surface. Review the install making sure all the studs are at the correct depth.

